

## Shared Living

Shared living differs from other forms of housing both in its flexibility and in the amount and quality of the amenity space included. Shared Living schemes maximise the use of communal areas for the benefit of residents, encouraging social behaviour and reducing rents to a more affordable level.

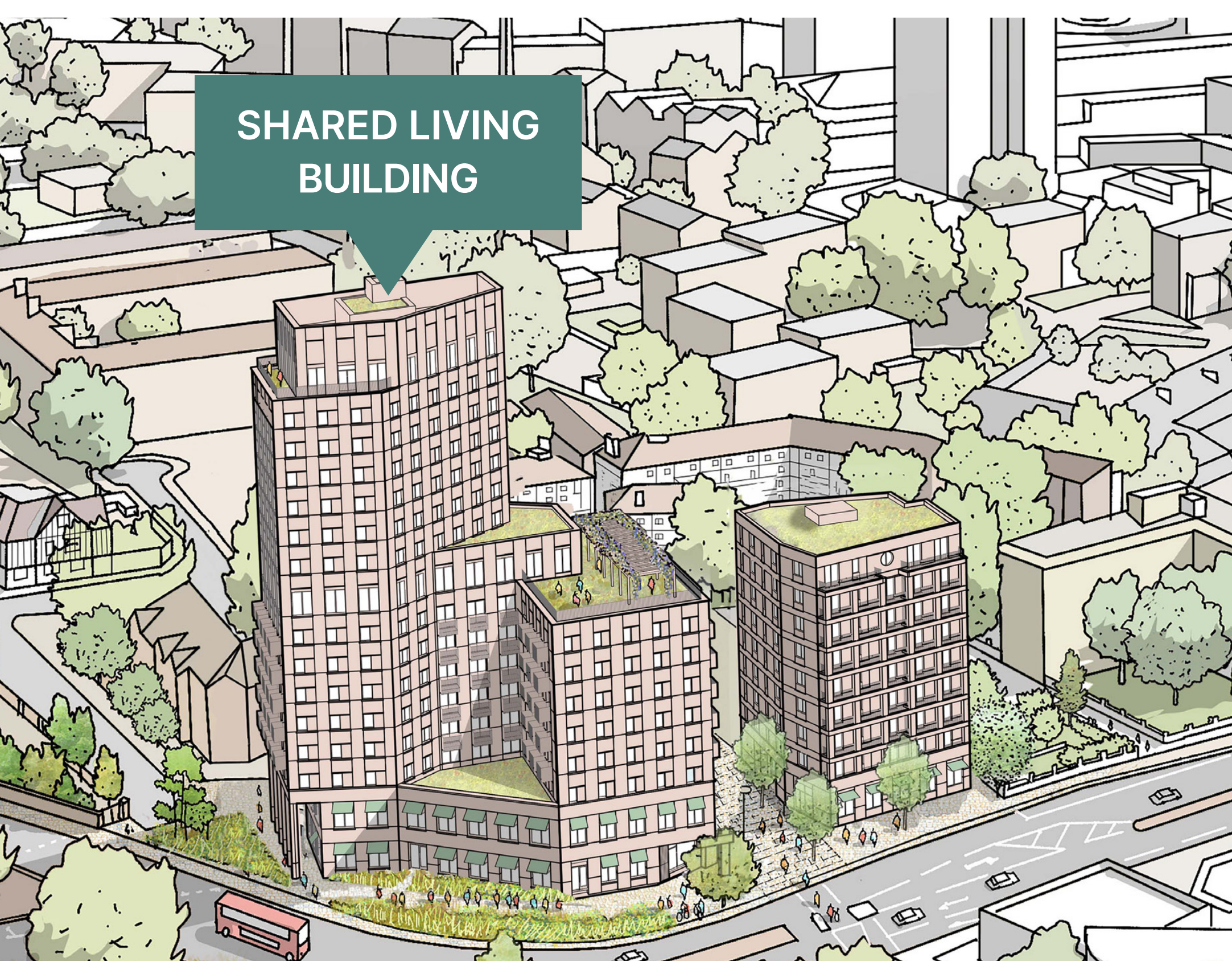

Community members have their own private space including a kitchenette and ensuite and hotel style bedrooms. At the same time they are able to benefit from public spaces including dining, entertaining and playing facilities, a gym, communal laundry and kitchen and dining areas.



Our proposals for St Olav's Court are for c216 shared living suites, a generous provision of communal amenity in line with emerging best practice and an upgrading of the commercial space. The shared living suites, amenity and public realm will be located in the left hand part of the development. They will be professionally managed by an experienced on-site operational team, ensuring that all facilities are well maintained.

The SoCo seeks to provide a home for residents who then become established and invested in their immediate and wider community.